

* 所有原料材质, 生产制程, 电镀必须符合HTR要求

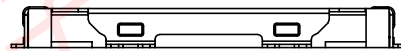
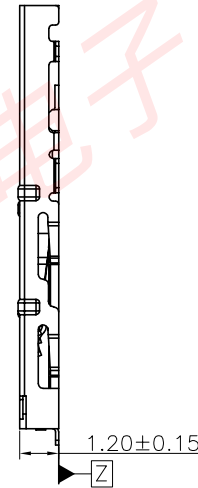
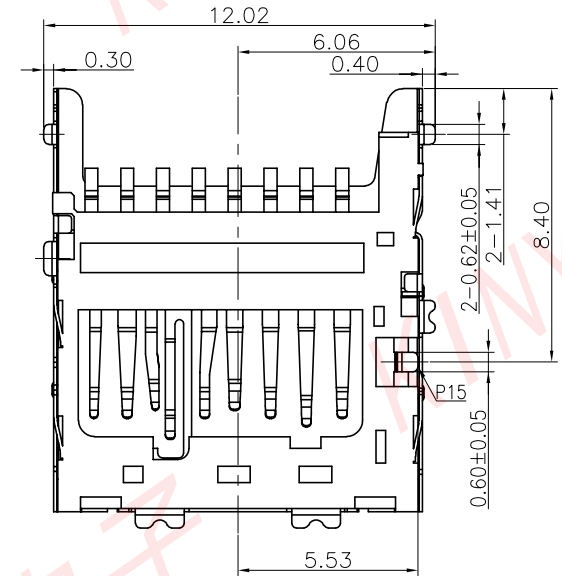
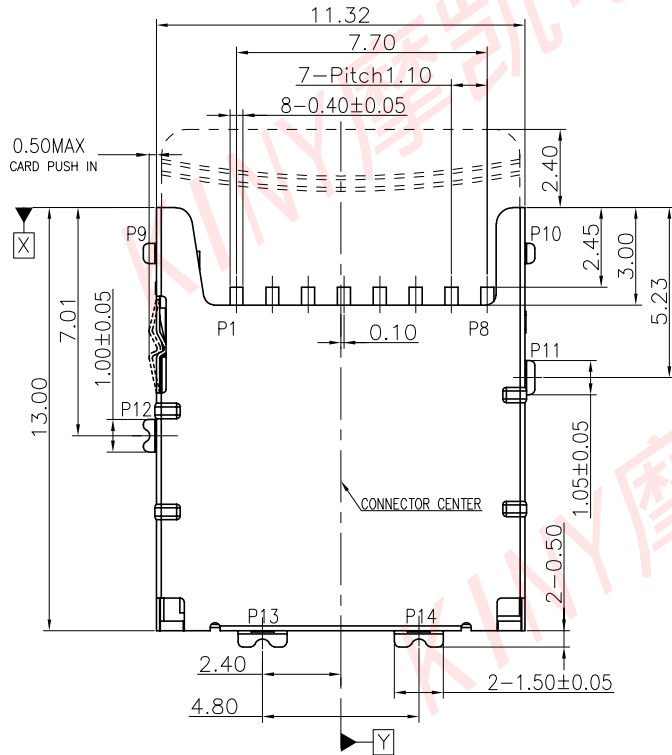
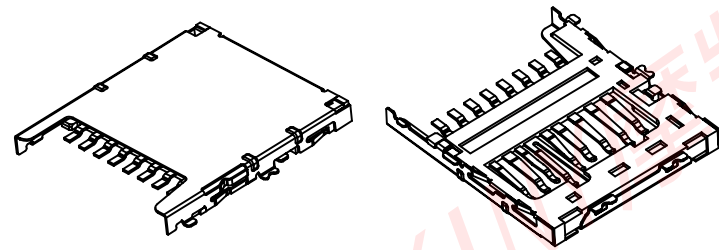
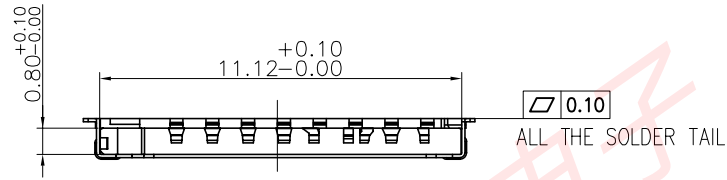

B	ER2008128	修改产品名称与系统内一致	pure	2020.08.22
A	----	NEW RELEASE	ping	2016.12.11
REVISION NO.	ECR NO.	DESCRIPTION	MARK	DATE

		东莞市摩凯电子有限公司			
		DIMENSIONS INIT: mm UNLESS OTHERWISE SPECIFIABLE	PRODUCT NAME : TF H1.15 connector	DRAWING: Pure	DATE: 2020.08.22
DIMENSION TOLERANCE X.X: ± 0.38 X.XX: ± 0.10 X.XXX: ± 0.05 ANGULAR: ± 2'	PRODUCT NO. : TF115-T1251-01	CHECK: Alex	DATE: 2020.08.22	APPROVED: Alex	DATE: 2020.08.22
	DRAWING NO. : D-TF115-T1251-01	SCALE: 1:1	DWG ID: C D	REV.: B	PAGE: 1 OF 2

* 所有原料材质, 生产制程, 电镀必须符合HTR要求

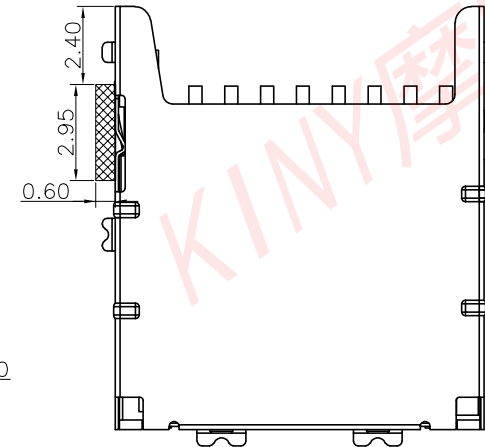
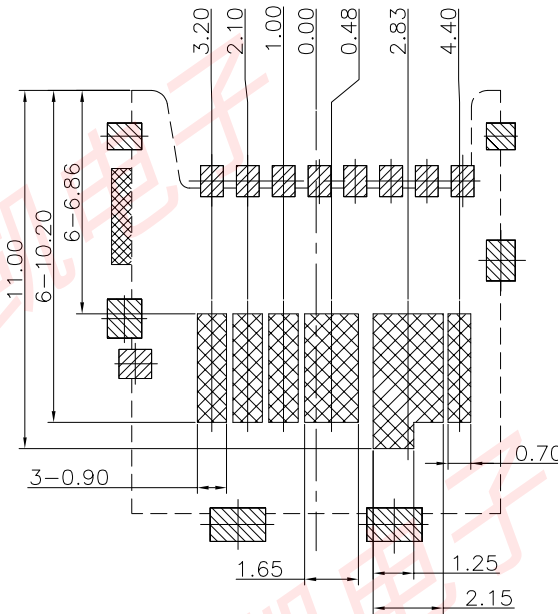
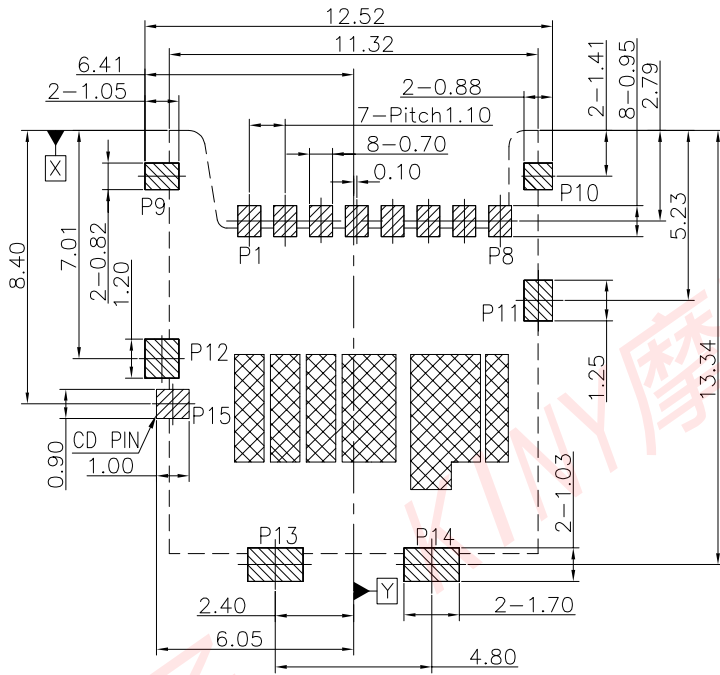

No component area

Pin Define	
P1	DAT2
P2	CD/DAT3
P3	CMD
P4	VDD
P5	CLK
P6	VSS
P7	DAT0
P8	DAT1
P9	GND
P10	GND
P11	GND
P12	GND
P13	GND
P14	GND
P15	CD

NOTE:

- Material:
 - Housing: High Temperature Thermoplastic, (LCP MG350) Color Black UL 94V-0
 - Contact: Phosphor Bronze (C5210R-SH T=0.12mm)
 - Cover: SUS304-H T=0.10mm
- Plating:
 - Contact terminal:
 - Contact area: Gold 1u" Min.
 - Solder area: Plated 80u" min Sn .
 - Underplating: Ni overall 50U" Min.
 - Cover:
 - Underplating: Ni overall 50U" Min.
 - Solder area: Gold 0.8u" Min .
- Specification:
 - Contact Current Rating: 0.5Amperes.
 - Dielectric Withstanding Voltage: AC500V r.m.s.
 - Insulation Resistance: 1000 Megohms
 - Minimum At DC 500V.
 - Contact Resistance: 100 mΩ Maximum.
 - Mating Cycles: 10,000 Cycles.
 - Operating Temperature: -25°C~+85°C.

- PAD AREA
- KEEP OUT AREA
- NO COPPER AREA
(NO Trace&Via&GND)
- GND PATTERN ONLY

REVISION NO.	ECR NO.	DESCRIPTION	MARK	DATE
B	ER2008128	修改产品名称与系统内一致	pure	2020.08.22
A	----	NEW RELEASE	ping	2016.12.11

		东莞市摩凯电子有限公司			
DIMENSION TOLERANCE X.X: ± 0.38 X.XX: ± 0.10 X.XXX: ± 0.05 ANGULAR: ± 2'		PRODUCT NAME : TF H1.15 connector	DRAWING: Pure	DATE: 2020.08.22	
		PRODUCT NO. : TF115-T1251-01	CHECK: Alex	DATE: 2020.08.22	
		DRAWING NO. : D-TF115-T1251-01	APPROVED: Alex	DATE: 2020.08.22	
		SCALE: 1:1	DWG ID: C D	REV.:	PAGE: 2 OF 2
			B		